

# FUSELAGE SUPPORT ASSEMBLY

## GEAR JACK MODELS GJ-FSA-STD

**1** Attach Stanchion Brackets to Carriage Block. Leave fasteners finger tight.

**2** Attach Clevis Halves to Lifting Tube Tang. Leave fastener finger tight.

**3** Attach Fuse Support Plate to Clevis Halves with (4) 8-32 x 1/4" Button Head Socket Screws. Tighten securely. **USE CARE TO AVOID CROSS THREADING SCREWS!**

**4** Before attaching the Double-Sided Tape, determine the margins around the Tape on the Fuse Support Plate and the Foam Pad.

**5** Remove the printed liner from the Double-Sided Tape and attach the tape to the Foam Pads.

**6** Remove the other liner from the Double-Sided Tape and attach the Foam Pads to the Fuse Support Plate.

**8** Slide Lifting Tube into Carriage Block.

**9** Adjust Lifting Tube and Fuse Support Plate and tighten fasteners securely.

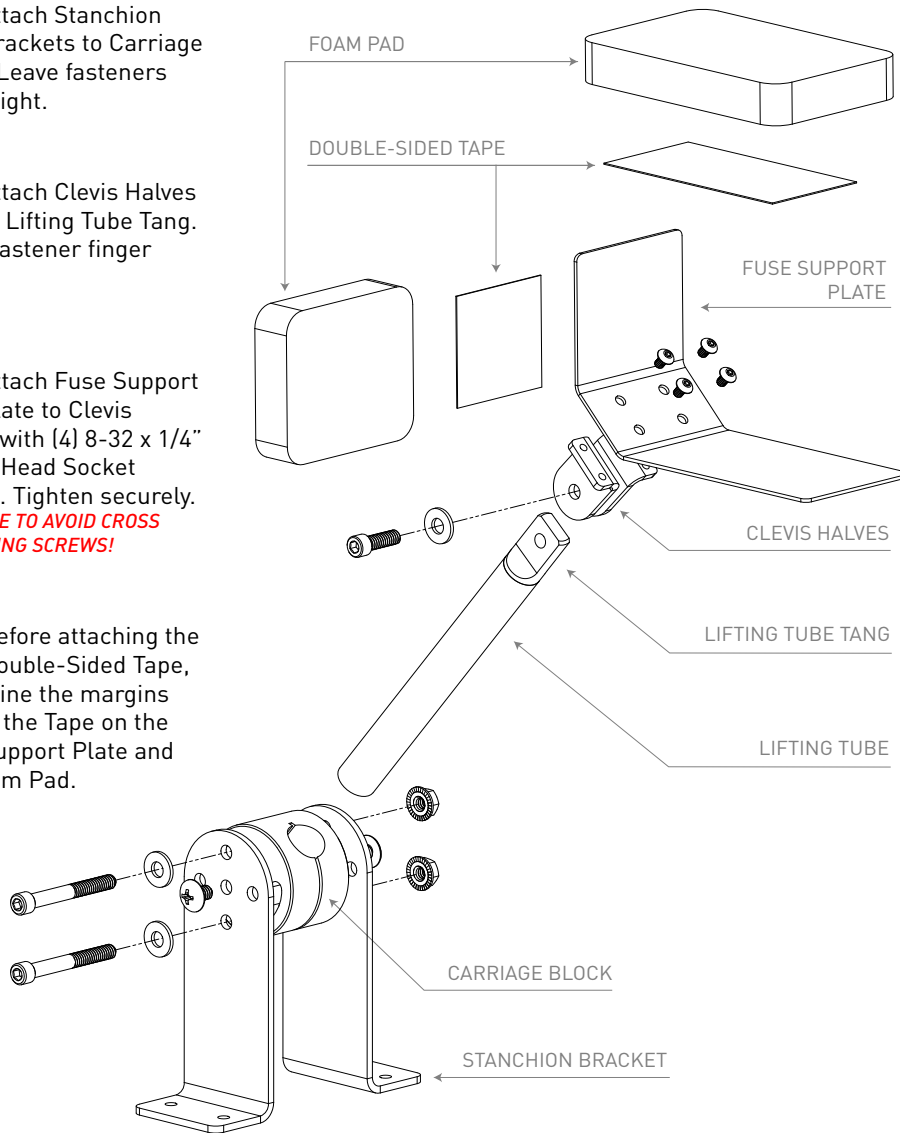

### TOOLS

Required: 3/32" Hex Key, 3/16" Hex Key, #2 Phillips screwdriver  
Optional: Thread locker (Blue Loctite®)

### NOTES:

1. At Step 1: With the Carriage Locking Bolts in the vertical pattern as shown, the Lifting Tube can swing +/- 40° from horizontal. With the Bolts in the horizontal pattern holes, the Lifting Tube can swing +/- 40° from vertical.
2. At Step 3: Take extra care to avoid cross threading Socket Head Screws.
3. At Step 3: Thread locker (Blue Loctite®) is not required but may be used.

